



BUILDING
SANITARY
ENVIRONMENT



BUILDING - SANITARY - ENVIRONMENT



SANITARY SOLUTIONS

The sanitary sector is a historic specialty of Nicoll and has made the brand a benchmark in the world of plumbing. The systems developed over 50 years have enabled generations of plumbers to work better, faster and more effectively and to improve with every job they do. Their performance in all types of building, whether new-build or renovation, is based on outstanding quality, giving users peace of mind and also saving them time. Meticulous observance of standards means they can be confident the products they are installing are fully complying with the regulations in force. Lastly, an exceptionally wide range ensures they can always acquire the parts they need, making life that much easier.

- Drainage fittings
- Acoustic drainage
- Multilayer pipes
- Pressure PVC
- Traps and drainage for sanitary appliances
- Washing machine traps
- Sanitary gullies
- Toilet pipes and fittings
- Accessories



CONTENTS

___ A SOLUTION FOR HEATING AND SANITARY INSTALLATIONS	4
___ QUALITY AND GUARANTEE	6
___ USE IN SINGLE AND MULTI-UNIT DWELLINGS	8
___ BENEFITS	9
___ AT THE CUTTING EDGE OF TECHNOLOGY	10
___ CONSULT ALL THE PRODUCTS IN THE COMPLETE RANGE	11





An intelligent system designed

HEATING AND SANITARY PROFESSIONALS

You want simple solutions that are both effective and versatile: the crimping assembly technology, combined with multilayer composite pipes, offers a wealth of new opportunities.

You will save time and make light of possible problems, offering a quality service and ensuring your jobs add real value. Compared with conventional techniques based on welding and brazing, the benefits for both your business and your customers are considerable.

MAKE PERFECT CONNECTIONS IN RECORD TIME

Both crimping and the multilayer method have a proven track record in northern Europe and Germany, where they are already being used. Said process, combined with hi-tech Nicoll components, gives you unbeatable reliability, longevity, and convenience.

It makes fast, clean, and totally secure installation work possible. This approach is now becoming more widely established and setting new quality standards for heating and sanitary installations.

So why not forge ahead with a market leader: enjoy tomorrow's standards today.





A SOLUTION FOR HEATING AND SANITARY INSTALLATIONS

to save you time

FILL YOUR ORDER BOOKS WITHOUT STRESS

Your jobs require you to be productive and effective on site. While maintaining professional techniques and results, the **Fluxo**[®] system enables you to:

- Save time on your jobs.
- Ensure you are delivering perfect work with no need for any after-sales work.
- Limit the amount of equipment needed on site.
- Reduce welding-related consumables.
- Protect your profit margins by avoiding fluctuations in the price of metals between your quoted price and when work begins on site.
- Avoid metal theft.



REMEMBER!

- Connections 3 times faster
- Improved productivity so you can take on more jobs
- Easier to meet deadlines
- No more threat of metal theft

Preparing the fitting: **5 seconds***

3



Crimping the fitting: **15 seconds***

4



* Estimated assembly times



QUALITY



Fluxo[®], quality without

FLUXO[®] PIPES BEND TO EVERY REQUIREMENT

Fluxo[®] multilayer pipes are easy to manipulate thanks to their flexibility, but mainly because they retain whatever shape you give them. This is due to their design, a 5-layer composite, combining synthetic materials with an intermediate layer made of high-quality aluminium. This is welded end to end using a 5 micron laser, which eliminates the risk of any weak points.



Expansion in mm based on a length of 4 m exposed to a change in temperature of 50°C

PER		50 mm
PVC		16 mm
Fluxo[®]		5.2 mm
Copper		3.3 mm
Galvanised steel		2.28 mm

By combining the properties of metals and synthetic materials in this way, **Fluxo[®]** offers unbeatable benefits:

- **Great flexibility in terms of bending**
- **Guarantee of the shape holding after bending**
- **Low thermal expansion**
- **Complete tightness to oxygen**
- **High resistance to corrosion**

Nicoll's expertise and mastery of composite material technology are your best guarantee of reliability. You can be confident of delivering perfect installations.





GUARANTEE

compromise

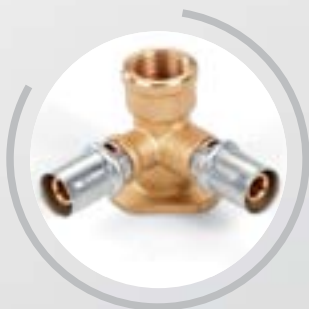

CARRY OUT ALL KINDS OF INSTALLATION WORK, WITH SUITABLE, SECURE FITTINGS

Nicoll's quality and performance standards apply to every element in the **Fluxo**[®] system:

- A complete system, certified by the CSTBat mark, with diameters from 16 to 63 mm (Technical Assessment: 14/08-1252*V1)
- **Fluxo**[®] fittings are made from a high-quality brass alloy, and consequently are completely resistant to corrosion.
- The seals ensure complete watertightness between the sleeve and the inner layer of the **Fluxo**[®] pipe.

10-YEAR GUARANTEE

The **Fluxo**[®] system has a 10-year guarantee, providing the installation work complies with the conditions outlined in our technical guide and the **Fluxo**[®] Technical Assessment. Any brand of crimping tool delivering a minimum pressing force of 15 kilonewtons up to Ø32. and 32 kilonewtons up to Ø63. can be used for assembly work.

These pressing tools must have jaws with a 'TH' profile.



113-1252 / 139-1252

Technical Assessment 14/08-1252 *V1





USE IN SINGLE AND MULTIPLE-UNIT DWELLINGS

Fluxo® gives you confidence - so you can be confident



USE THE SAME SYSTEM FOR ALL YOUR HEATING AND SANITARY INSTALLATIONS

The advantage of **Fluxo®** is its great versatility. This means you can use it for all your jobs:

- Small or big networks, from the riser to the horizontal branches
- Single or multiple-unit dwellings or commercial buildings
- Heating and sanitary applications
- Concealed in new-build projects or surface-mounted in renovations

Fluxo® makes everything quicker and easier.

FLUXO® MAKES HEAVY EQUIPMENT AND METAL PIPES A THING OF THE PAST

Your job involves a lot of handling work : accessibility and working conditions on site can be problematic.

Fluxo® offers you tremendous benefits:

- No need to carry heavy, bulky, and dangerous equipment anymore
- As far as tools are concerned, there is a practical, compact case for everything you need to produce reliable installations: the electric crimping tool and the jaws for each fitting type.
- The multilayer pipes are light enough for one person to carry them with ease: this means they can be stored safely in your vehicle when you finish work in the evening.





BENEFITS

ce in your equipment
with your customers



FLUXO® HAS EVERYTHING YOU NEED TO SATISFY YOUR CUSTOMERS

With **Fluxo**® installations, customer satisfaction is guaranteed:

Hygiene

- **Fluxo**® meets the requirements and latest hygiene standards relating to drinking water.
- It has been granted Sanitary Conformity Certification (*Attestation de Conformité Sanitaire - ACS*) by the CARSO Laboratory for Health, the Environment, and Hygiene in Lyons (Ref. Nicoll 08 MAT LY 081 and NICOLL 10 MAT LY 013 for the pipes, Ref. Nicoll 09 ACC LY 01 and Ref. Nicoll 09 ACC Ly 002 for the fittings).

Safety

- No more fire risks from welding torches
- No more hot work licences
- No more burns to carpets or paintwork
- Your customers have peace of mind, and you also leave their sites beautifully tidy: they do not even need to repaint the pipes.

Reliability

- The contractual guarantee is for 10 years, but the system is actually designed to last for more than 50 years (as well as being tested by the CSTB).
- You could even do your own burst test on a **Fluxo**® pipe using a test pump: you will be surprised to find it can withstand more than 110 bars.

Acoustics

- The **Fluxo**® system absorbs noises caused by circulating fluid and water hammer.
- Your customers will be amazed by the acoustic quality of their installation.



REMEMBER!

- Suitable for use in heating and sanitary installations
- Can be used in new-build and renovation projects
- Can be used in single/multiple-unit dwellings or commercial buildings
- Significant time savings
- Exceptional product quality
- Perfect finish



At the cutting edge of technology

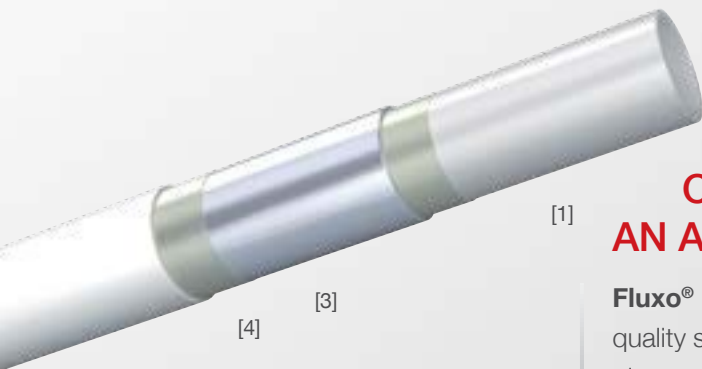

MULTILAYER PIPES: COMPOSITES WITH AN ALUMINIUM CORE

[1]

Fluxo® pipes use a composite of aluminium and very high-quality synthetic materials. The aluminium core ensures the water pipes you install experience less thermal expansion than plastic materials. The outer layer protects the aluminium against possible causes of corrosion, while the inner layer is designed for contact with water. **Fluxo**® pipes meet the requirement of the Drinking Water Certification (Attestation de Conformité Sanitaire - ACS).

[5]

Take a closer look at its design, a product of Nicoll's technological expertise:

[1] and [5] Inner and outer layer made of cross-linked polyethylene (PEX)

[2] and [4] Intermediate adhesive layer

[3] Aluminium core

INNER AND OUTER LAYERS MADE OF CROSS-LINKED POLYETHYLENE (PEX):

Exceptional temperature resistance

The cross-linking process it undergoes makes PEX more resistant over time to the hot and cold cycles that it will experience in a heating circuit.

Anti-corrosion

The inner and outer PEX layers ensure the aluminium layer is completely protected.

Acoustics

The PEX layers absorb much of the noise caused by circulating fluid and water hammer, making life much more pleasant for your customers.

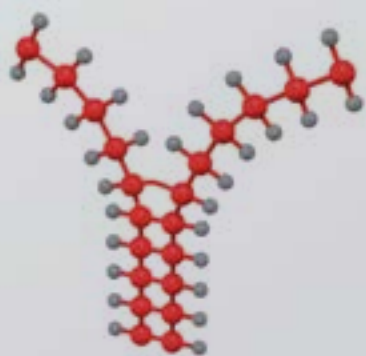

Cross-linked polyethylene (PEX).
Permanent linking of molecular chains via cross-linking.

INNER ALUMINIUM CORE:

- Welded end-to-end using a 5 micron laser able to withstand the highest pressure
- Forms a perfect barrier against oxygen and UV rays to tackle silting up
- Makes the pipe easy to shape

MULTILAYER PIPES



Reference	Diam. x thickness (mm)	Length (ml)
COILED PIPES (for concealed applications)		
FLEM100C16	16x2	100
FLEM200C16	16x2	200
FLEM100C20	20x2	100
FLEM50C26	26x3	50
FLEM50C32	32x3	50



Reference	Diam. x thickness (mm)	Length (ml)	Metres per pack
STRAIGHT PIPES (for surface-mounted applications)			
FLEM4L16	16x2	4	100 m (25 sections)
FLEM4L20	20x2	4	64 m (16 sections)
FLEM4L26	26x3	4	40 m (10 sections)
FLEM4L32	32x3	4	28 m (7 sections)
FLEM5L40	40x3.5	5	25 m (5 sections)
FLEM5L50	50x4	5	25 m (5 sections)
FLEM5L63	63x4.5	5	15 m (3 sections)



Reference	Diam. x thickness (mm)	Length (ml)	Sheath
PRE-SHEATHED, COILED PIPES (for built-in applications where water temperature may exceed 60°)			
FLEM50GB16	16x2	50	Blue
FLEM50GR16	16x2	50	Red
FLEM100FB16	16x2	100	Blue
FLEM100FR16	16x2	100	Red
FLEM50GB20	20x2	50	Blue
FLEM50GR20	20x2	50	Red



Reference	Diam. x thickness (mm)	Length (ml)	Insulation
PRE-INSULATED, COILED PIPES			
<small>(ø 16 mm: insulation Class 2 in compliance with the NF EN 12828 standard for insulation used in sanitary and heating applications (outside the heated area) and according to RT2005 (Réglementation Thermique, France's heating legislation) ø 20 and 26 mm: insulation Class 1 based on the NF EN 12828 standard for insulation used in sanitary applications and according to RT2005 (Réglementation Thermique, France's heating legislation))</small>			
FLEM50G10P16	16x2	50	10 mm (Class 2)
FLEM50G10P20	20x2	50	10 mm (Class 1)
FLEM50G10P26	26x3	50	10 mm (Class 1)
FLEM25G10P32	32x3	25	10 mm



Nicoll Fluxo multilayer pipe	Unit	Fluxo 16	Fluxo 20	Fluxo 26	Fluxo 32	Fluxo 40	Fluxo 50	Fluxo 63
TECHNICAL CHARACTERISTICS								
External diameter	mm	16	20	26	32	40	50	63
Thickness of pipe	mm	2	2	3	3	3.5	4	4.5
Internal diameter of pipe	mm	12	16	20	26	33	42	54
Pipe weight when empty	g/ml	110	150	300	370	430	500	1350
Pipe weight when full	g/ml	223	360	614	901	1285	1885	3640
Internal volume	liters/ml	0.113	0.210	0.314	0.531	0.855	1.385	2.29
Thermal expansion coefficient	mm/m/°C	0.026	0.026	0.026	0.026	0.026	0.026	0.026
Internal roughness	mm	0.007	0.007	0.007	0.007	0.007	0.007	0.007
Thermal conductivity	W/m°C	0.40	0.40	0.40	0.40	0.40	0.40	0.40
Minimum manual bend radius	mm	80	100	110	160	550	700	-
Minimum bend radius with a bending tool	mm	45	60	95	125	180	210	315



Perfect fittings for 16 up to 63 mm diameters

FAST, RELIABLE, AND SECURE INSTALLATIONS ...

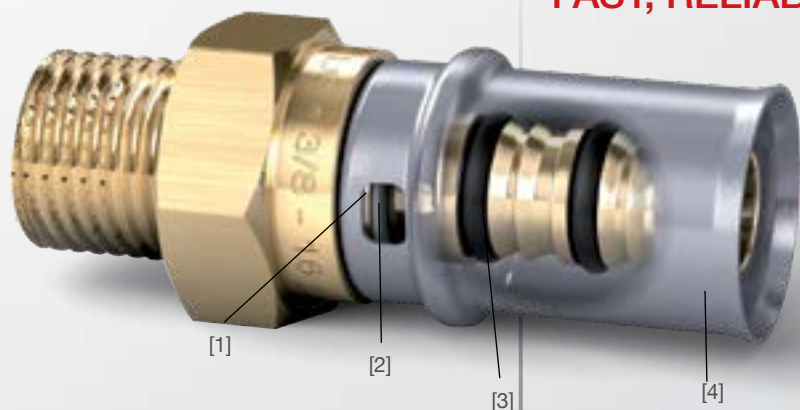

[1] Dielectric seal. It prevents all contact between the aluminium and brass, thereby avoiding any battery effect.

[2] Indicates pipe is correctly inserted.

[3] Double EPDM peroxide-cross-linked seal. Top quality EPDM.

[4] Large ring made of stainless steel 304. Stainless steel 304 provides rings with resistance to corrosion and high compression on the pipe.

The press fittings in the **Fluxo**[®] range are designed for fast implementation, whatever the installation type, with all the reliability and safety guarantees you would expect: resistance to both corrosion and changes in temperature or pressure, completely watertight seal between the sleeve and the inner layer of the **Fluxo**[®] pipe. They are made from

a high-quality brass alloy, which meets **Nicoll's** usual exacting standards.

WHY HAVE A TH PRESSING PROFILE?

Nicoll has chosen to use the TH crimping profile. Its position as the most widely used version in the market is no coincidence. It ensures that the fitting is perfectly held between the jaws during pressing. Our entire range uses this same profile, for diameters from 16 up to 63 mm.

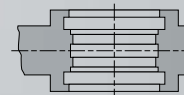

YOUR EQUIPMENT

If you already have a crimping tool and jaws with the TH profile, you can immediately start using **Fluxo**[®] with your existing equipment without having to buy a **Nicoll** 'branded' machine. You will be covered, **thanks to Technical Assessment which includes all makes of pressing tool delivering a minimum pressing force of 15 kilonewtons up to Ø40 and 32 kilonewtons up to Ø63.**

If you have a crimping tool whose jaws have a different profile, you simply have to change these.



REMEMBER!

- Easy installation
- Highly resistant to corrosion
- Perfectly watertight
- Sanitary Conformity Certification (*Attestation de Conformité Sanitaire - ACS*)
- A wide range to cover all configurations of the installation
- Quality raw materials
- Compatible with most crimping tools on the market



PRESS PIPE CONNECTORS

Reference	Diameter (mm)	Z1 (mm)	Z2 (mm)	Length (L) (mm)
-----------	---------------	---------	---------	-----------------

COUPLER PRESS PIPE CONNECTORS

FLM16	16x16	6.2	6.2	66
FLM20	20x20	6.2	6.2	66
FLM26	26x26	6.5	6.5	66
FLM32	32x32	7.5	7.5	68
FLM40	40x40	11.5	11.5	84
FLM50	50x50	11.5	11.5	102
FLM63	63x63	14.5	14.5	108

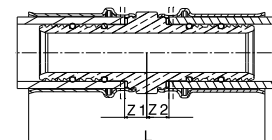

REDUCER PRESS PIPE CONNECTORS

FLM2016	20x16	6.2	6.2	66
FLM2616	26x16	6.5	6.2	66
FLM2620	26x20	6.5	6.2	66
FLM3216	32x16	7.5	7.2	68
FLM3220	32x20	7.5	7.2	68
FLM3226	32x26	7.5	7.2	68
FLM4020	40x20	15.4	11.2	80
FLM4026	40x26	11.5	11.5	80
FLM4032	40x32	11.5	11.5	80
FLM5020	50x20	16.7	11.5	91.5
FLM5026	50x26	12.2	12.2	90.5
FLM5032	50x32	11.8	11.8	89.5
FLM5040	50x40	11.5	11.5	91.5
FLM6340	63x40	12.8	12.8	95.5
FLM6350	63x50	12	12	103

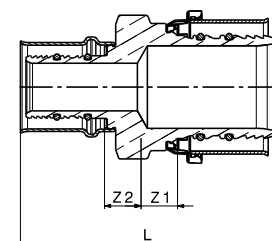

ADAPTERS WITH MALE THREAD, FIXED MALE TO BE SCREWED

FLM1612M	16x3/8" (12/17)	15.2	57
FLM1615M	16x1/2" (15/21)	15.2	57
FLM1620M	16x3/4" (20/27)	15.2	57
FLM2015M	20x1/2" (15/21)	15.2	57
FLM2020M	20x3/4" (20/27)	15.2	57
FLM2615M	26x1/2" (15/21)	17.5	59
FLM2620M	26x3/4" (20/27)	17.5	59
FLM2626M	26x1" (26/34)	17.5	61
FLM3226M	32x1" (26/34)	19.5	63
FLM4033M	40x1 1/4 (33/42)	22.5	73
FLM5040M	50x1 1/2 (40/49)	19.5	79
FLM6350M	63x2" (50/60)	23.5	89

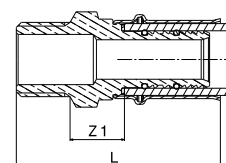

ADAPTERS WITH FEMALE THREAD, FIXED FEMALE TO BE SCREWED

FLM1615F	16x1/2" (15/21)	26.7	53.5
FLM1620F	16x3/4" (20/27)	26.7	53.5
FLM2015F	20x1/2" (15/21)	26.7	53.5
FLM2020F	20x3/4" (20/27)	26.7	53.5
FLM2026F	20x1" (26/34)	31.2	58
FLM2620F	26x3/4" (20/27)	26.3	53
FLM2626F	26x1" (26/34)	31.3	58
FLM3226F	32x1" (26/34)	25.5	52
FLM3233F	32x1 1/4 (33/42)	32	58.5
FLM4033F	40x1 1/4 (33/42)	31	59
FLM5040F	50x1 1/2 (40/49)	31	68
FLM6350F	63x2" (50/60)	37.5	76

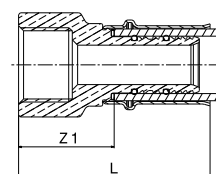

PRESS PIPE CONNECTORS AND TEE PIECES



Reference	Diameter (mm)	Z1 (mm)	Height (H) (mm)	Length (L) (mm)
ADAPTERS WITH SWIVEL NUT				
FLMT1612F	16x3/8" (12/17)	21		49.5
FLMT1615F	16x1/2" (15/21)	21		48
FLMT1620F	16x3/4" (20/27)	21		48
FLMT2015F	20x1/2" (15/21)	21		50.5
FLMT2020F	20x3/4" (20/27)	21		48
FLMT2620F	26x3/4" (20/27)	27.5		60
FLMT2626F	26x1" (32/42)	21.5		57.5
FLMT3226F	32x1" (33/42)	29		63
FLMT3233F	32x1 1/4 (40/49)	21.5		56.5
FLMT4033F	40x1 1/4 (33/42)	25.5		52
FLMT5040F	50x1 1/2 (40/49)	31.5		71
FLMT6350F	63x2" (50/60)	36		74

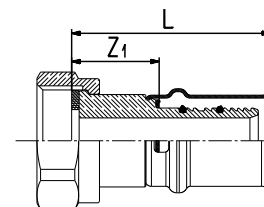

Reference	Diameter (mm)	Z1 (mm)	Height (H) (mm)	Length (L) (mm)
ADAPTERS WITH SWIVEL NUT M22				
FLM16M22F	16xM22	23		50
FLM20M22F	20xM22	28		55

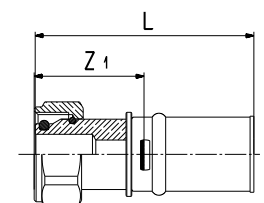

Reference	Diameter (mm)	Z1 (mm)	Height (H) (mm)	Length (L) (mm)
FLUXO TRANSITION TO COPPER PIPES				
FLM16CU14F	16x copper pipe 14 mm	9.2		62.3
FLM16CU15F	16x copper pipe 15 mm	25.5		62.3
FLM16CU16F	16x copper pipe 16 mm	9.2		62.3
FLM20CU18F	20x copper pipe 18 mm	9.2		62.8
FLM20CU22F	20x copper pipe 20 mm	23.2		59.9

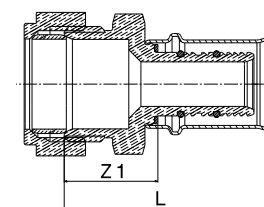

Reference	Diameter (mm)	Z1 (mm)	Height (H) (mm)	Length (L) (mm)
EQUAL TEE PIECES				
FLT16	16x16x16	23.7	46.5	93
FLT20	20x20x20	23.2	50	100
FLT26	26x26x26	25.3	52	104
FLT32	32x32x32	28.5	55	110
FLT40	40x40x40	35.5	66	132
FLT50	50x50x50	42.5	82	164
FLT63	63x63x63	47.5	87	174

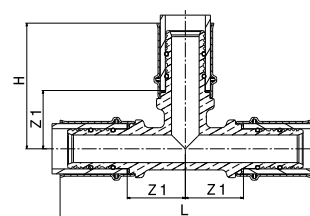

Reference	Diameter (mm)	Z1 (mm)	Height (H) (mm)	Length (L) (mm)
REDUCED TEE PIECES				
FLT162016	16x20x16	23.2	50	100
FLT201616	20x16x16	23.2	50	100
FLT201620	20x16x20	23.2	50	100
FLT202016	20x20x16	23.2	50	100
FLT202620	20x26x20	26.2	53	106
FLT261616	26x16x16	25.3	53	105
FLT261620	26x16x20	25.3	53	105
FLT261626	26x16x26	25.3	52	104
FLT262016	26x20x16	25.3	53	105
FLT262020	26x20x20	25.3	52	104

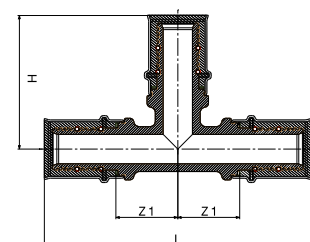



PRESS TEE PIECES

Reference	Diameter (mm)	Z1 (mm)	Height (H) (mm)	Length (L) (mm)
REDUCED TEE PIECES (CONTINUED)				
FLT262026	26x20x26	25.3	52	104
FLT262616	26x26x16	25.3	52	104
FLT262620	26x26x20	25.3	52	104
FLT263226	26x32x26	29.3	55	112
FLT321632	32x16x32	28.5	55	110
FLT322026	32x20x26	28.5	55	110
FLT322032	32x20x32	28.5	55	110
FLT322626	32x26x26	28.5	55	110
FLT322632	32x26x32	28.5	55	110
FLT402040	40x20x40	33.5	62	132
FLT402640	40x26x40	33.5	62	132
FLT403240	40x32x40	42.5	62	132
FLT501650	50x16x50	42.5	69	164
FLT502050	50x20x50	42.5	69	164
FLT502650	50x26x50	42.5	69	164
FLT503250	50x32x50	42.5	69	164
FLT504040	50x40x40	42.5	73	164
FLT504050	50x40x50	42.5	73	164
FLT632663	63x26x63	47.5	74	174
FLT633263	63x32x63	47.5	74	174
FLT634063	63x40x63	47.5	78	174
FLT635063	63x50x63	47.5	87	174

TEE PIECES WITH FEMALE THREAD

FLT1615F	16x1/2" (15/21)	21.7	35	97
FLT2015F	20x1/2" (15/21)	23.2	35	100
FLT2020F	20x3/4" (20/27)	23.2	35	100
FLT2615F	26x1/2" (15/21)	25.3	40	104
FLT2620F	26x3/4" (20/27)	25.3	43	103.6
FLT3215F	32x1/2" (15/21)	28.5	45	110
FLT3220F	32x3/4" (20/27)	28.5	45	110
FLT3226F	32x1" (26/34)	28.5	45.5	110
FLT4020F	40x3/4" (20/27)	35.5	33	132
FLT4033F	40x1 1/4" (33/42)	35.5	56	132
FLT5020F	50x3/4" (20/27)	42.5	37	164
FLT5040F	50x1 1/2" (40/49)	42.5	37	164
FLT6320F	63x3/4" (20/27)	47.5	42	174
FLT6350F	63x2" (50/60)	47.5	73	174

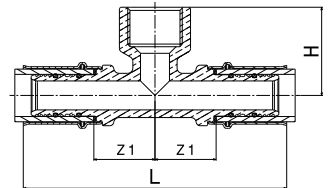

TEE PIECES WITH MALE THREAD

FLT1615M	16x1/2" (15/21)	21.7	35	97
FLT1620M	16x3/4" (20/27)	21.5	35	97
FLT2015M	20x1/2" (15/21)	23.2	35	100
FLT2020M	20x3/4" (20/27)	23.2	35	100
FLT2620M	26x3/4" (20/27)	25.3	43	103.6
FLT3226M	32x1" (26/34)	28.5	45.5	110
FLT4033M	40x1 1/4" (33/42)	35.5	57	132
FLT5040M	50x1 1/2" (40/49)	42.5	64.5	164

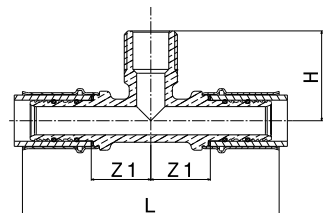



PRESS ELBOWS

Reference	Diameter (mm)	Z1 (mm)	Height (H) (mm)	Length (L) (mm)
PRESS ELBOWS 90°				
FLC16	16x16	23.7		46.5
FLC20	20x20	23.7		50
FLC26	26x26	25.3		51.8
FLC32	32x32	28.5		55
FLC40	40x40	35.5		66
FLC50	50x50	42.5		82
FLC63	63x63	47.5		87
PRESS ELBOWS WITH FEMALE THREAD				
FLC1615F	16x1/2" (15/21)	21.7	33.5	48.5
FLC2015F	20x1/2" (15/21)	23.2	33.5	50
FLC2020F	20x3/4" (20/27)	23.2	35	50
FLC2620F	26x3/4" (20/27)	25.3	40	51.8
FLC2626F	26x1" (26/34)	28.5	40	55
FLC3226F	32x1" (26/34)	28.5	45.5	55
FLC4033F	40x1 1/4 (33/42)	35.5	56	66
FLC5040F	50x1 1/2 (40/50)	42.5	64.5	82
FLC6350F	63x2" (50/60)	47.5	73	87
PRESS ELBOWS WITH MALE THREAD				
FLC1612M	16x3/8" (12/17)	21.7	35	48.5
FLC1615M	16x1/2" (15/21)	21.7	35	48.5
FLC2015M	20x1/2" (15/21)	23.2	35	50
FLC2020M	20x3/4" (20/27)	23.2	35	50
FLC2620M	26x3/4" (20/27)	25.3	43	51.8
FLC2626M	26x1" (26/34)	25.3	40.5	51.8
FLC3226M	32x1" (26/34)	28.5	45.5	55
FLC4033M	40x1 1/4 (33/42)	35.5	56	66
FLC5040M	50x1 1/2 (40/49)	42.5	69.5	82
FLC6350M	63x2" (50/60)	47.5	73	87
PRESS ELBOWS WITH SWIVEL NUTS				
FLCT1615F	16x1/2" (15/21)	21.7	35	48.5
FLCT1620F	16x3/4" (20/27)	23.2	35	50
FLCT2015F	20x1/2" (15/21)	23.2	35	50
FLCT2020F	20x3/4" (20/27)	23.2	35	50
FLCT2620F	26x3/4" (20/27)	25.5	38	52
FLCT3233F	32x1 1/4 (33/42)	28.5	43	55
FLUXO/COPPER TRANSITION ELBOWS				
FLC16CU15F	16xTU/CU15 mm	21.7	40.5	48.5
FLC20CU22F	20xTU/CU22 mm	23.2	44.9	50
PRESS ELBOWS 45°				
FLC440	40x40	27	57.5	112
FLC450	50x50	29	68.5	133.5
FLC463	63x63	30.5	70	140

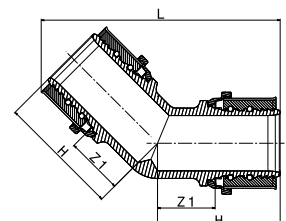
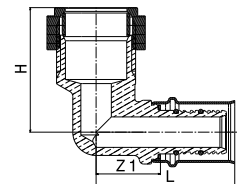
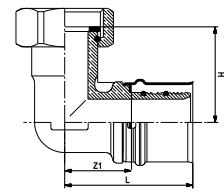
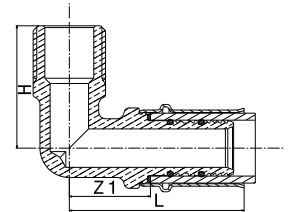
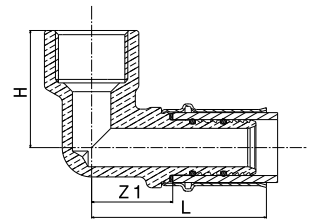
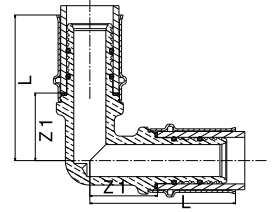

VALVE ELBOWS FOR WC CISTERN PRESS WALL PLATE ELBOWS AND PRESS PIPES COMPRESSION FITTINGS



Reference	Diameter (mm)	Z1 (mm)	Height (H) (mm)	Length (L) (mm)
-----------	---------------	---------	-----------------	-----------------

VALVE ELBOW FOR WC CISTERN

FLCR1612F	16x3/8" (12/17)	23	39	78.5
-----------	-----------------	----	----	------

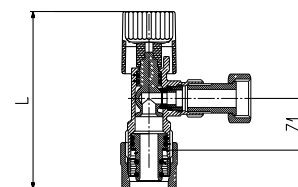

PRESS WALL PLATE ELBOWS WITH FEMALE THREAD

FLCA1615F	16x1/2" (15/21)	26.2	53	53
FLCA2015F	20x1/2" (15/21)	26.2	53	53
FLCA2020F	20x3/4" (20/27)	26.2	53	53

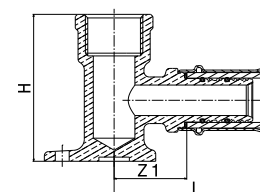

DOUBLE PRESS WALL PLATE ELBOWS WITH FEMALE THREAD

FLCAD1615F	16x1/2" (15/21)	26.2	49	53
FLCAD2015F	20x1/2" (15/21)	26.2	49	53

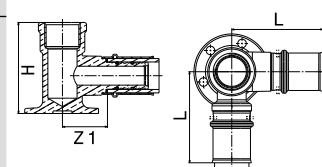

PRESS WALL PLATE ELBOWS WITH FEMALE THREAD AND WALL MOUNTING BRACKET

FLSM1615F	16x1/2" (15/21)	21.2	51.5	48
FLSM2015F	20x1/2" (15/21)	21.2	51.5	48

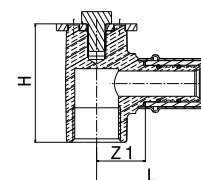

PRESS PIPES

FLCS3016	16	53	300
FLCS11016	16	53	1100

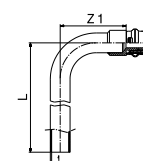

COMPRESSION FITTINGS FOR MANIFOLD

FLMP1615F	16x1/2" (15/21)	3.7	20.7
FLMP1620F	16x3/4" (20/27)	1	24.1
FLMP2020F	20x3/4" (20/27)	2.5	27.7

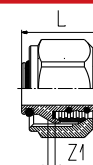

MALE COMPRESSION FITTINGS, NICKEL-PLATED FOR HEATING

FLMPN1612M	16x3/8" (12/17)	9.6	35.5
FLMPN1615M	16x1/2" (15/21)	9.6	36.5
FLMPN2015M	20x1/2" (15/21)	10.7	40.5
FLMPN2020M	20x3/4" (20/27)	11.2	43

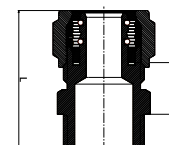

OUTLET MANIFOLDS AND PLUGS TO BE SCREWED



Reference		Number of 1/2" outlets	Threading (R) (inches)	Height (H) (mm)	Length (L) (mm)
Colour, blue	Colour, red				
MANIFOLDS WITH 1/2" MALE THREADED OUTLETS, FOR HEATING					
COLR2SB20M	COLR2SR20M	2	3/4" (20/27)	75	83
COLR3SB20M	COLR3SR20M	3	3/4" (20/27)	75	118
COLR4SB20M	COLR4SR20M	4	3/4" (20/27)	75	153
COLR2SB26M	COLR2SR26M	2	1" (26/34)	79	90
COLR3SB26M	COLR3SR26M	3	1" (26/34)	79	125
COLR4SB26M	COLR4SR26M	4	1" (26/34)	79	158

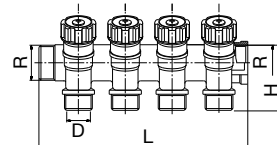

MANIFOLDS WITH 1/2" MALE THREADED OUTLETS

COL2S20M	2	3/4" (20/27)	52	83
COL3S20M	3	3/4" (20/27)	52	118
COL4S20M	4	3/4" (20/27)	52	153
COL5S20M	5	3/4" (20/27)	52	193
COL2S26M	2	1" (26/34)	56	90
COL3S26M	3	1" (26/34)	56	125
COL4S26M	4	1" (26/34)	56	158
COL5S26M	5	1" (26/34)	56	193

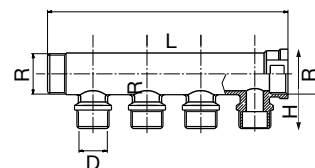

MANIFOLDS END PLUGS

BC15F	1/2" (15/21)	24
BC20F	3/4" (20/27)	32
BC26F	1" (26/34)	39
BC33F	1"1/4 (33/42)	50

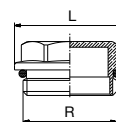



ADJUSTMENT VALVES

Reference	Diameter (D) (inches/mm)	Threading (A) (mm)	Height (H) (mm)	Length (L) (mm)
-----------	-----------------------------	-----------------------	--------------------	--------------------

ADJUSTMENT VALVES, SQUARE FEMALE



RRADE12F	3/8" (12/17)		69.5	78.5
RRADE15F	1/2" (15/21)		69	78.5
RRADE20F	3/4" (20/27)		69	78.5

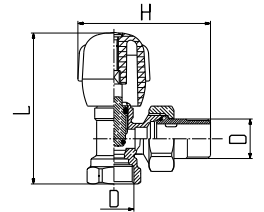

ADJUSTMENT VALVES, SQUARE MALE



RRADE12M	3/8" (12/17)	24x19	69.5	78.5
RRADE15M	1/2" (15/21)	24x19	69	78.5

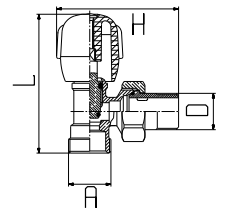

ADJUSTMENT VALVES, STRAIGHT MALE



RRADD12M	3/8" (12/17)		78	67
RRADD15M	1/2" (15/21)		80	67
RRADD20M	3/4" (20/27)		81	83

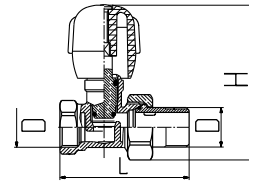

ADJUSTMENT ELBOWS, SQUARE FEMALE



CRADE12F	3/8" (12/17)		62	45.5
CRADE15F	1/2" (15/21)		64	45.5
CRADE20F	3/4" (20/27)		82	47

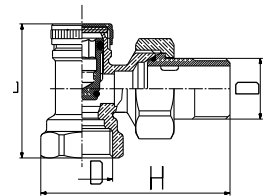

ADJUSTMENT ELBOWS, SQUARE MALE



CRADE12M	3/8" (12/17)	24x19	61	45.5
CRADE15M	1/2" (15/21)	24x19	62	45.5

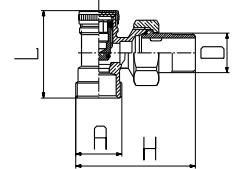

ADJUSTMENT TEES, FEMALE





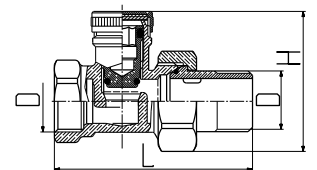



TRAD12F	3/8" (12/17)		45.5	67
TRAD15F	1/2" (15/21)		47.5	67
TRAD20F	3/4" (20/27)		50	83





CRIMPING TOOLS

		Reference	
MINI CRIMPING TOOL UP TO A DIAMETER OF 40 MM			
 <p>Mini-Press ACC</p>		578012	<p>Mini-Press ACC run on Li-Ion battery Crimping tool with mini battery for radial crimping with automatic circuit control (ACC)</p> <ul style="list-style-type: none"> • Press fitting assembly work, Ø16–40 mm • Runs on an Li-Ion battery or via the mains • Can only be used with mini pressing jaws (provided separately) • Universal and easy-to-use electrical tool • Secure and ultra-fast crimping • Ideal weight distribution for one-handed use • Pressing jaw locks automatically
  <p>14.4 V/1.3 Ah battery for mini Mini pressing jaw</p>		571540	14.4 V/1.6 Ah Li-Ion battery
		578352	Mini TH 16 pressing jaw
		578358	Mini TH 20 pressing jaw
		578362	Mini TH 26 pressing jaw
		578364	Mini TH 32 pressing jaw
		578624	Mini TH 40 pressing jaw
WIRED CRIMPING TOOL UP TO A DIAMETER OF 75 MM			
 <p>Power Press ACC</p>		577010	<p>Power Press ACC Electro-hydraulic crimping tool for radial crimping with automatic circuit control (ACC)</p> <ul style="list-style-type: none"> • Press fitting assembly work, Ø10-76 (108) mm • Can be used with pressing tools, including those of other brands • Universal and easy-to-use electrical tool • Secure and ultra-fast crimping • Pressing jaw locks automatically
BATTERY-POWERED CRIMPING TOOL UP TO A DIAMETER OF 63 MM			
  <p>Akku Press ACC 14.4 V/2 Ah batteries, basic pack</p>		571014	<p>Akku Press ACC Electro-hydraulic crimping tool run on 14.4 V/2.2 Ah Li-Ion battery with automatic circuit control (ACC) for piston return</p> <ul style="list-style-type: none"> • Press fitting assembly work, Ø10-76 (108) mm • Runs on a battery or via the mains • Can be used with pressing jaws, including those of other brands • Universal and easy-to-use electrical tool • Secure and ultra-fast crimping • Pressing jaw locks automatically
		571550	14.4 V/2.2 Ah Li-Ion batteries
PRESSING CLAWS FOR UNIVERSAL CRIMPING TOOLS (UP TO A DIAMETER OF 63 MM)			
 <p>Pressing jaw</p>		570460	TH 16 pressing jaw
		570470	TH 20 pressing jaw
		570475	TH 26 pressing jaw
		570480	TH 32 pressing jaw
		570485	TH 40 pressing jaw
		572400	TH 50 (S) pressing jaw
		572405	TH 63 (S) pressing jaw

BENDING AND CUTTING TOOLS



Reference

SWING BENDING TOOL



Swing

153023

Swing 16-18-20-25/26-32 crossbow-style, multilayer bending tool
One-handed bending tool for pipes

- Practical, one-handed tool for precise pipe bending up to 90°. Ideal for work on site. Universal application for many pipes. Speeds up tasks thanks to patented rapid forward-reverse movement. Tested and reliable ratchet-driven forward motion. Also ideally suited to coated pipes.
- Composite pipes, Ø14-32 mm
- Annealed copper pipes, Ø10-22 mm or 3/8-7/8" s ≤ 1 mm
- Annealed, coated copper pipes, Ø10-18 mm or 3/8-5/8" s ≤ 1 mm
- Coated steel pipes from the Mapress C-STAHl press fitting system, Ø12-18 mm
- Precision, annealed steel pipes, Ø10-18 mm s ≤ 1 mm

EXTERNAL BENDING SPRINGS (Square cross-section ensures pipes are not damaged)



External bending springs for pipes

V-700001

External bending spring for pipes with 16 mm diam.

V-700003

External bending spring for pipes with 20 mm diam.

V-700006

External bending spring for pipes with 26 mm diam.

V-700005

External bending spring for pipes with 32 mm diam.

ROS PIPE CUTTER



Ros P 35 A

291220

ROS P 35 A
Scissors for pipes up to 35 mm

- Automatic rapid-return feature
- Quality, easy-to-use tool for quick and neat cutting of pipes. Also ideal for pipes with thin walls. Sturdy model made from aluminium.



Ros P 42

291250

ROS P 42
Scissors for pipes up to 42 mm

- Rapid-return feature
- Quality, easy-to-use tool for quick and neat cutting of pipes. Also ideal for pipes with thin walls. Sturdy model made from aluminium.

PIPE PREPARATION TOOLS AND INSPECTION DOORS

CALIBRATORS - INTERNAL AND EXTERNAL CHAMFER TOOLS, FOR SCREWDRIVER OR WITH TURNING HANDLE



Case containing a handle and calibrators in diameter 16.20 and 26 mm



Calibrators

Reference

N00003 Case containing a handle and calibrators 16. 20. and 26 mm

IM0001 Handle for fixing chamfer calibrators

CA0002 Calibrator, diameter 16 mm

CA0004 Calibrator, diameter 20 mm

CA0005 Calibrator, diameter 26 mm

CA0006 Calibrator, diameter 32 mm

CA0007 Calibrator, diameter 40 mm

CA0008 Calibrator, diameter 50 mm

CA0009 Calibrator, diameter 63 mm

MANUAL MUTLI-DIAMETER CALIBRATORS (AND INTERNAL CHAMFER TOOLS)



Manual calibrators with handle, 4 diameters (16/20/26/32 mm)



Manual calibrators with handle, 3 diameters (40/50/63 mm)

N80001 Manual calibrator with handle, 4 diameters (16/20/26/32 mm)

N80002 Manual calibrator with handle, 3 diameters (40/50/63 mm)

PIPE STRAIGHTENERS AND UNCOLLERS



Pipe straighteners with rollers



Fixing vices on workbenches



Coil uncollers with 3 legs



Pipe adaptors/straighteners on pipe uncollers

V-900000 Pipe straightener with rollers

V-900000T Fixing vice on workbench for straightener with rollers

V-900040 Uncoller with 3 legs

V-900000A Pipe adaptor/straightener on pipe uncoller

INSPECTION DOOR



1TV24

Inspection door (airtight)
- Int. dimensions 24x24 cm
- Ext. dimensions 30x30 cm



Another reason for choosing Fluxo®: the quality of NICOLL's service



You know the quality **Nicoll** demands of all its products.

We have made specific resources available to provide you with the day-to-day support you need when using the **Fluxo**® system. These include the following:

- A mobile team of **Fluxo**® Technical Consultants, who can come to your premises or visit your sites as required to train you on **Fluxo**®
- Practical courses at our Training Centre to share this new expertise with you or enhance your knowledge of crimping techniques
- **Fluxo**® Distribution Partners to ensure a reliable and plentiful supply

Technical Support:

Tel.: +33 (0)2 41 63 73 25

Fax: +33 (0)2 41 63 73 23





BUILDING - SANITARY - ENVIRONMENT



Head office and factories: 37. rue Pierre & Marie Curie - BP 10966 - 49309 CHOLET Cedex // Tel. +33 (0)2 41 63 73 83 - Fax +33 (0) 41 63 73 84

Requests for documentation: info@nicoll.fr // Technical enquiries: tech-com.nicoll@alixis.com

SAS (PLC) with a capital of €7,683,431 - 060 200 128 RCS Angers

an *Aliaxis* company