

CEILING TRAP DOOR TP2012I51

Building

NEW

La trappe TP2012I51 a été conçue pour répondre aux nouvelles exigences de la réglementation thermique RT2012.

Advantages :

- Thermal resistance $R=7.5 \text{ m}^2 \text{ K/W}$
- Optimum airtightness
- Thermal and sound insulation
- Patented opening/closing system
- Ideal for LEB construction



CEILING TRAP DOOR TP2012 I 51

Building



New ceiling trap door TP2012I51 :

The response to the environmental challenges of RT 2012

REFERENCES	a INSIDE DIMENSIONS	b EMBEDDABLE DIMENSIONS	c OUTSIDE DIMENSIONS	d HEIGHT OF THE FRAME	e INSULATING HEIGHT
TRAPPE DE PLAFOND 51 X 51 cm					
 TP2012I51	510	550	580	103	330 mini

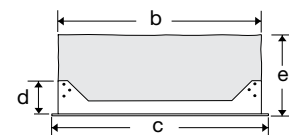

USE

• Ceiling trap door providing access to the attic. The trap door can be made lockable or tamperproof using separate kits. The trap door's specific characteristics in terms of the seal and insulation are particularly well suited when constructing energy-saving buildings (RT2012, HPE (High Energy Performance), THPE (Very High Energy Performance), etc.).

DESCRIPTION

- White polystyrene-injected cover and frame.
- Recycled polyester wool insulation which can be recycled.

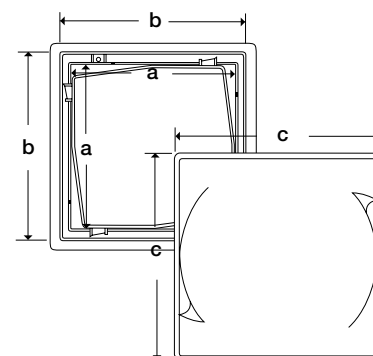

ADVANTAGES

- Perfect airtightness.
- High-level insulating capacities $R=7.5m^2$ K/W, complies with RT2012.
- Environmentally friendly: recycled insulation which can be recycled.
- Level of sound insulation compliant with NRA: min. 42dba.
- Easy to install: light, patented closing and opening system.
- Aesthetically pleasing: the frame is entirely covered, and all types of paint can be used for this.



Find us on
www.trappes-nicoll.com

INSTALLATION

• Fix the frame to the wooden or other support (an insulation riser can be installed between the frame and the support). A perfect seal between the ceiling and the frame can be obtained by placing a mastic sealant on the frame.

Opening

Turn the trap in an anti-clockwise direction in order to lower it on its 4 safety stops. Then, turn slightly in the opposite direction in order to release the frame.

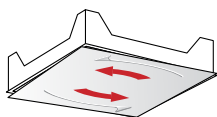

Closing

Simply align the corners of the trap door with those of the frame and just press to pivot it in a clockwise direction.

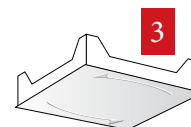
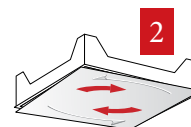
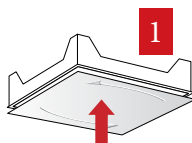

BÂTIMENT - SANITAIRE - ENVIRONNEMENT



Head office and industries : 37, rue Pierre et Marie Curie - BP 10966 - 49309 CHOLET Cedex // Tél. 02 41 63 73 83 - FAX 02 41 63 73 84 - www.nicoll.fr
Email : info@nicoll.fr // Technical request : tech-com.nicoll@alixis.com // SAS (PLC) with a capital of 7 683 431 euros - 060 200 128 RCS Angers